

POINSETT AND CRAIGHEAD COUNTY
Annual Taxpayer Transparency Improvement District Report*

Name of recorded district POINSETT WATERSHED DISTRICT

1. Formation Date MARCH 1967

2. Formation Statute ARK. STATUTES 21-901 THROUGH 21-924

3. Description of district's boundaries (Attachment: map of district)

MAP OF DISTRICT WITH 21 LAKES AND DITCH ON EAST SIDE. NO OTHER MAP OF BOUNDARY HAS BEEN FOUND.

4. District's commissioners, directors, or officers (name, phone number, address, email, term of Office)

a. CHAIR: DAVID CLINES, 5917 HARRISBURG ROAD, JONESBORO AR 72404

b. TELE: 870 931 8317; E-MAIL CLINESFARM@SUDDENLINK.NET

c. JIMMY CARL KING, 601 BROOKS ST., HARRISBURG AR 72432

d. TELE: 870 408 1884,

e. BIZAD CLINES, 6015 HARRISBURG ROAD, JONESBORO, AR 72404

f. TELE: 219 5797; E-MAIL DOUBLECFARMS@SUDDENLINK.NET

g. RONNIE EVERHART, 16008 HWY 163, J. BORO, 72404; 870 219 2434;

h. C.A. JONES, 22205 PINEVIEW ROAD, TRUMAN, AR 72472. THE BOARD AND I FAIL TO FIND JONES. DO NOT HAVE TELE # OR E-MAIL. WILL CONTINUE TO TRY.

i. Vacancies on the district board or commission

NONE

NOTE: WATERSHED LAW DOES NOT SET UP TERM LIMITS FOR COMMISSIONERS

Annual Meeting

2ND FRIDAY, JANUARY 9:00 AM

TO BE DETERMINED

Date

Time

Location

7. General description of district's current and future maintenance and repairs

GENERAL MAINTNANCE OF EACH OF DISTRICT 21 DAMS, AND
THE DRAINAGE DITCH ON THE EAST SIDE OF THE RIDGE

8. Contracts (identity of parties to contracts and district's obligations)

a. None

b.

c.

d.

9. Current Indebtedness or Bond Indebtedness (with reason for indebtedness and payout or maturity date)

a. None

b.

c.

d.

10. Total existing delinquent assessments AS OF 5/10/22, 25 PARCELS, \$813.95

Responsible Delinquent Collector COUNTY TAX COLLECTORS, POINSETT AND
CRAIGHEAD COUNTIES

1. District Assessor (name, phone number, address, email)

None

2. Payee for distribution from County Treasurer (name, phone number, email)

CHARLES FRIERSON, 870 932 6643; CDFRIERSON3@HOTMAIL.COM

13. Explanation of statutory penalties, interest, and cost

AS SET OUT IN GENERAL STATE LAW

14. Method used to calculate assessments (flat fee; per acre; per structure; etc.)

BASED ON ASSESSMENT OF BENEFITS PER ACRE SET WHEN
DISTRICT WAS FORMED IN 1967

15. Statement itemizing the income and expenditures of the district for the most recent fiscal year (Attachment: balance sheet/bank statement)

INDEPENDANT ACCOUNTING FOR YEAR ENDING 12-31-21
IS ATTACHED

Completed By:

CHARLES TRIFILSON

Print Name

870 932 6643

Phone Number



Signature

6/13/22

Date

*Required by Arkansas Code Act 359 of 2021

Form provided by: Wes Eddington
Craighead County Collector

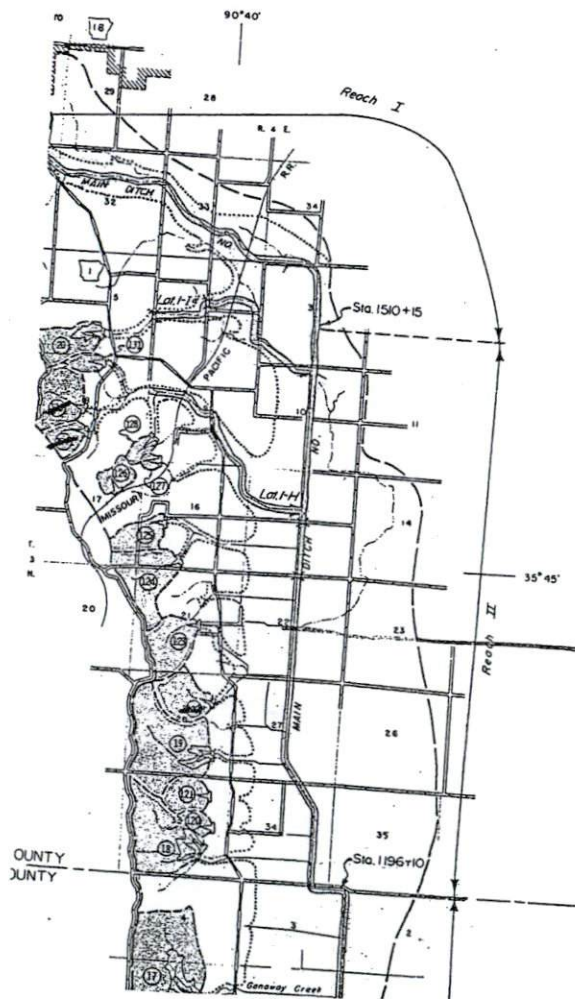

NOTE: REVISED PLANS ELIMINATE LATERAL DITCHES. WORK TO BE DONE ON MAIN DITCH ONLY.

NORTH END OF DITCH WORK

STRUCTURE NUMBERS AND DRAINAGE AREAS IN ACRES

Str. No.	Acres	Str. No.	Acres
1	1560	107	138
2	474	108	43
3	290	109	82
4	928	110	38
5	344	111	54
6	393	112	61
7	1213	113	261
8	559	114	75
9	361	115	207
10	817	116	58
11	330	117	138
12	192	118	64
13	408	119	178
14	326	120	22

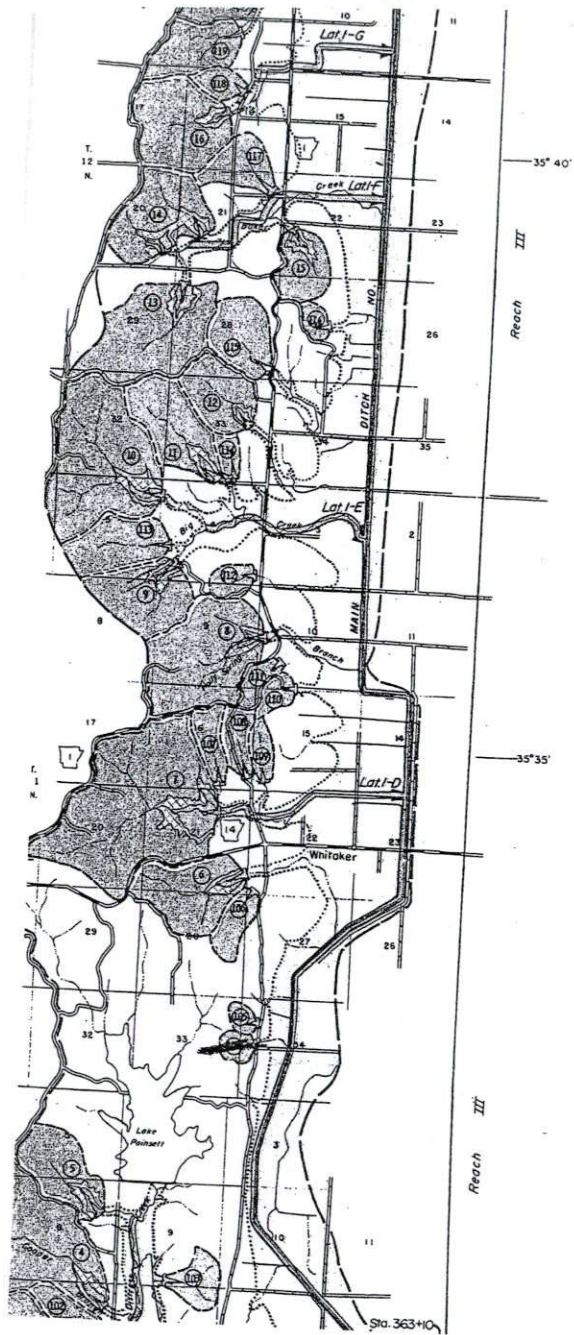

17	186	121	54
16	285	122	112
17	433	123	138
18	233	124	203
19	341	125	66
20	91	126	88
21	410	127	26
101	106	128	28
102	90	129	99
103	96	130	224
104	73	131	35
105	46	132	83
106	64	133	88

LEGEND

- Paved Road
- Improved Road
- Unimproved Road
- County Line
- Section Line and Number
- Railroad
- Town or Community
- Drainage
- Lake or Pond
- Watershed Boundary
- Bridge or Culvert to be Installed
- Drainage Area Controlled by Structure
- Area Benefited
- Floodwater Retarding Structure
- Channel Improvement for Flood Prevention
- Structure Number
- Reaches
- Station Number



101	106	128	2
102	90	129	9
103	96	130	22
104	73	131	3
105	46	132	8
106	64	133	8

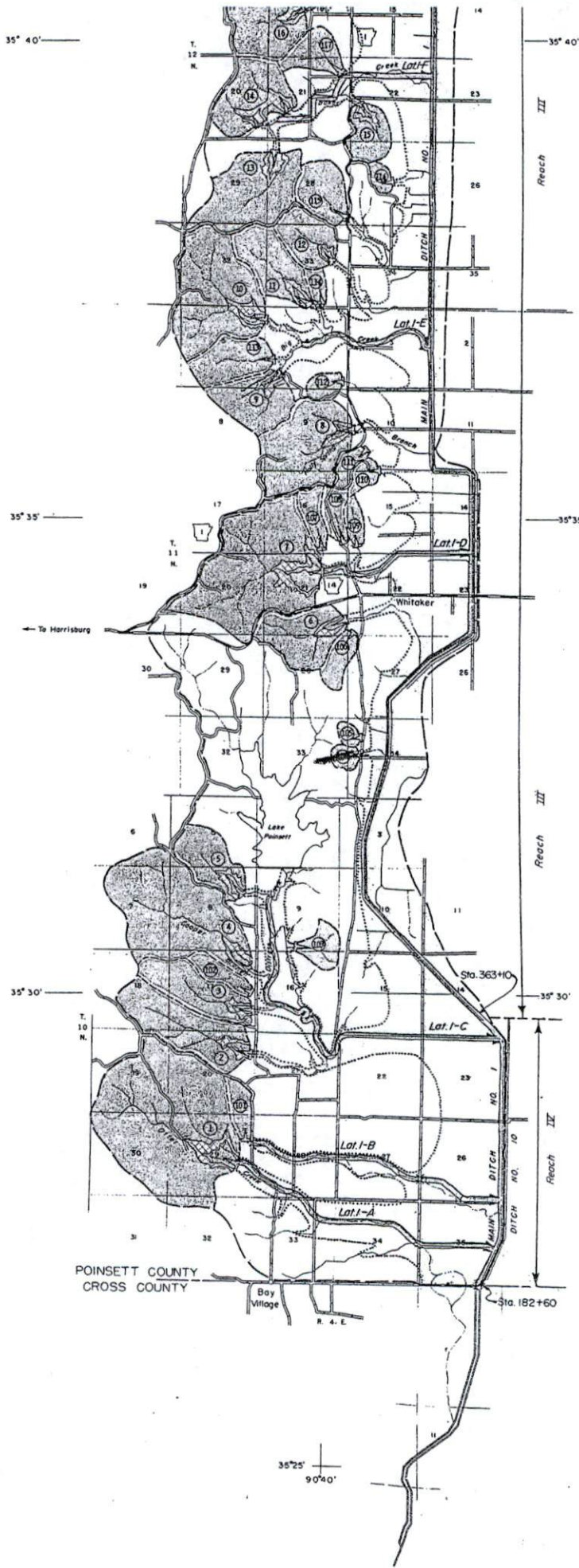

LEGEND

- Paved Road
- Improved Road
- Unimproved Road
- County Line
- Section Line and Number
- Railroad
- Town or Community
- Drainage
- Lake or Pond
- Watershed Boundary
- Bridge or Culvert to be Installed
- Drainage Area Controlled by Structure Area Benefited
- Floodwater Retarding Structure
- Channel Improvement for Flood Prevention
- Structure Number
- Reaches
- Station Number



PROJECT MAP
POINSETT WATERSHED
CRAIGHEAD AND POINSETT COUNTIES
ARKANSAS

U. S. DEPARTMENT OF AGRICULTURE
SOIL CONSERVATION SERVICE
LITTLE ROCK, ARKANSAS



Base Compiled from U.S.G.S. Quads.

dls



despain luther short & company

901 Windover Road | Jonesboro, AR 72401 | 870-932-5401 | 870-972-1141

INDEPENDENT ACCOUNTANTS' COMPILATION REPORT

To the Commissioners
Poinsett Watershed District
Jonesboro, Arkansas

Management is responsible for the accompanying statement of cash receipts and disbursements of Poinsett Watershed District (a governmental entity) for the year ended December 31, 2021, and for determining that the cash basis of accounting is an acceptable financial reporting framework. We have performed a compilation engagement in accordance with Statements on Standards for Accounting and Review Services promulgated by the Accounting and Review Services Committee of the AICPA. We did not audit or review the financial statements nor were we required to perform any procedures to verify the accuracy or completeness of the information provided by management. Accordingly, we do not express an opinion, a conclusion, nor provide any form of assurance on these financial statements.

The financial statements are prepared in accordance with the cash basis of accounting, which is a basis of accounting other than accounting principles generally accepted in the United States of America.

Management has elected to omit substantially all the disclosures ordinarily included in financial statements prepared in accordance with the cash basis of accounting. If the omitted disclosures were included in the financial statements, they might influence the user's conclusions about the Company's cash receipts and disbursements. Accordingly, the financial statements are not designed for those who are not informed about such matters.

*Despain, Luther, Short
& Company, CPAs, PA*

Jonesboro, AR
January 21, 2022



POINSETT WATERSHED DISTRICT
STATEMENT OF CASH RECEIPTS AND DISBURSEMENTS
YEAR ENDED DECEMBER 31, 2021

CASH RECEIPTS	
POINSETT COUNTY TAX COLLECTED	\$ 6,351.77
CRAIGHEAD COUNTY TAX COLLECTED	5,409.36
CERTIFICATE OF DEPOSIT CASHED	0.00
INTEREST EARNED ON CHECKING	43.08
INTEREST EARNED ON CERTIFICATE OF DEPOSIT	0.00
	<u>11,804.21</u>
 CASH DISBURSEMENTS	
ATTORNEY FEES - CHARLES FRIERSON	70.00
ACCOUNTING FEES - DESPAIN LUTHER SHORT & CO CPAS PA	375.00
DAM PERMITS - AR SOIL & WATER CONSERVATION DISTRICT	0.00
DAM MAINTENANCE	10,000.00
MEETING FEES	0.00
BANK CHARGES	0.00
FILING FEES	90.00
USDA REFUND	0.00
NATIONAL WATERSHED COALITION	75.00
	<u>10,610.00</u>
 INCREASE (DECREASE) IN CASH	 1,194.21
 CASH IN BANK - DECEMBER 31, 2020	 <u>57,465.98</u>
 CASH IN BANK - DECEMBER 31, 2021	 <u>\$ 58,660.19</u>
 INVESTMENTS AT DECEMBER 31, 2021	
 CERTIFICATE OF DEPOSIT - EVOLVE BANK & TRUST	 \$ 104,984.35

SEE INDEPENDENT ACCOUNTANTS' COMPILATION REPORT